

Executive Summary

Prescott-Centerpoint East

Narrative: The total parcel is comprised of approximately 8.33 acres and is located off of Side Road in Centerpoint East Commerce Park. This property is zoned Commercial/Industrial. The uniqueness of this property is the location and being adjacent to Empire CAT Industrial Business. All utilities are to the property. Please call listing office for more information.

Address: 3058 Centerpoint East
Prescott, AZ 86305

Parcels: 103-01-583P, 103-01-030J
Centerpoint East Commerce Park

Property:	Commercial	8.33 Acres
	Square Feet	362,855
	Total Gross Acres	± 8.33 Acres

Price:	\$ 2,175,000.00
Per Square Foot	\$ 6.00
Per Acre	\$ 261,733.00
Terms	Cash, CNV

ELIO S. KHALIFE
FIRST AMERICAN INVESTMENT, LLC
3200 Lakeside Village Drive, Suite 201
Prescott, AZ. 86301
Phone (928) 541-1557
Fax: (928) 541-1561

The above information was delivered from a source deemed reliable. We have no reason to doubt the accuracy, but make no representation or warranties, expressed or implied to the accuracy of this information.



Map scale = 1:2888

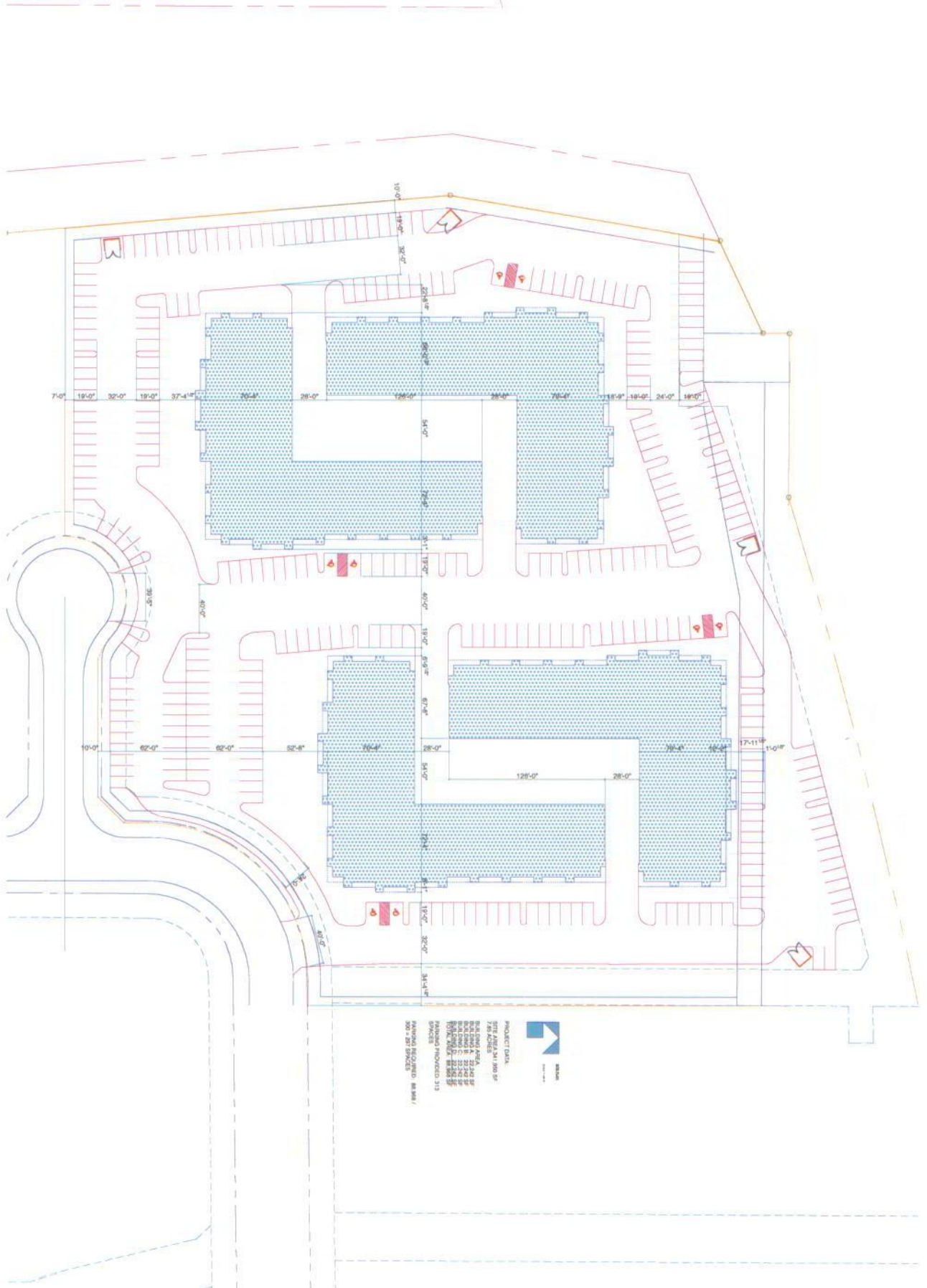

PROJECT DATA
 SITE AREA: 1,100 SF
 BUILDING AREA:
 BUILDING A: 22,242 SF
 BUILDING B: 22,242 SF
 BUILDING C: 22,242 SF
 BUILDING D: 22,242 SF
 TOTAL BUILDING AREA: 89,010 SF
 PARKING PROVIDED: 313 SPACES
 PREPARED BY: MANNING BROSCHNIGER ARCHITECTS
 DATE: 08-15-2011

